



FITTING INSTRUCTIONS FOR LP0236BK LICENCE PLATE BRACKET
YAMAHA X-MAX '17-



THIS KIT CONTAINS THE ITEMS PICTURED AND LABELLED BELOW.
DO NOT PROCEED UNTIL YOU ARE SURE ALL PARTS ARE PRESENT.

Please note that the way the kit is packed does not necessarily represent the way of mounting to the bike.

THE PARTS SHOWN MAY BE REPRESENTATIVE ONLY (FOR CLARITY OF INSTRUCTIONS ONLY).

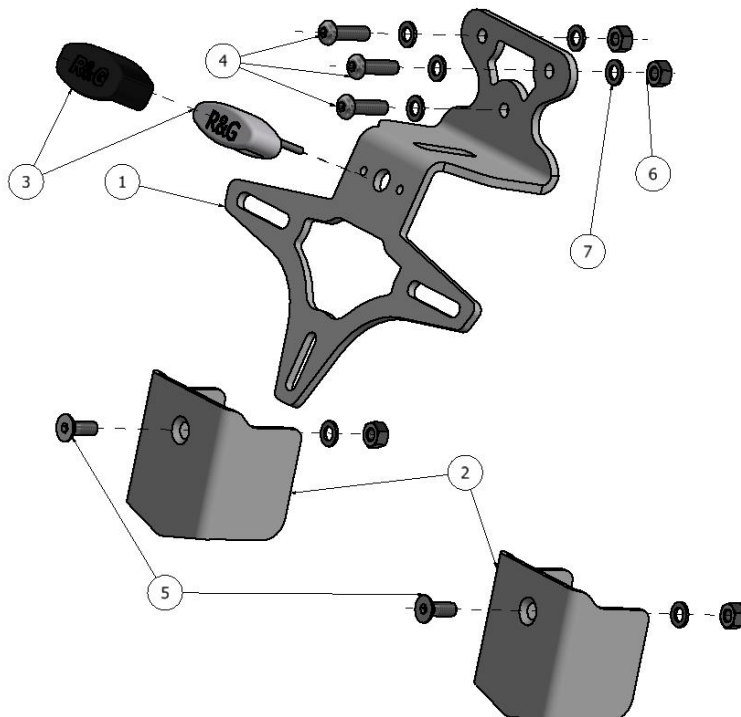

R&G

Unit 1, Shelley's Lane, East Worldham, Alton, Hampshire, GU34 3AQ
Tel: +44 (0)1420 89007 Fax: +44 (0)1420 87301 www.rg-racing.com Email: info@rg-racing.com

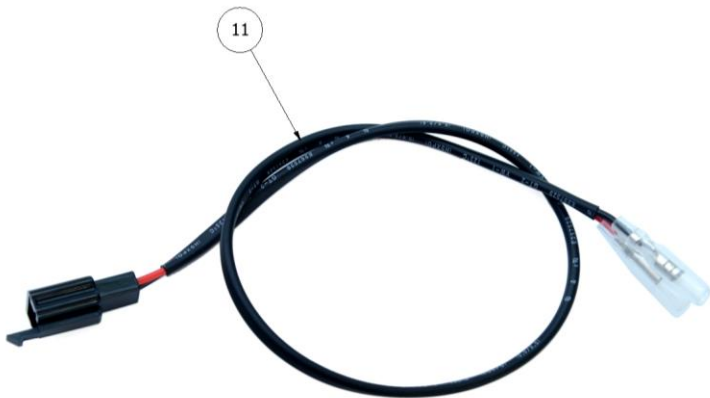
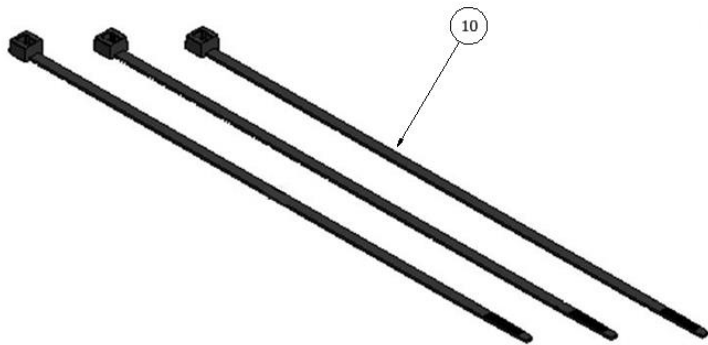
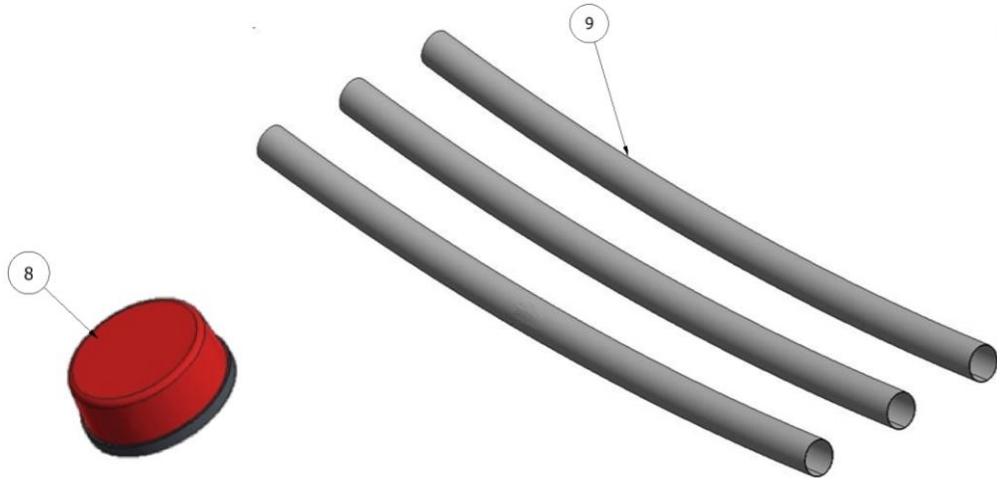



LEGEND

- ITEM 1 = LICENCE PLATE BRACKET PART 1 (TB0236 PART 1) (x1).
- ITEM 2 = LICENCE PLATE BRACKET PART 2 (TB0236 PART 2) (x2).
- ITEM 3 = LICENCE PLATE ILLUMINATOR & SHROUD (LA0002) (x1).
- ITEM 4 = M6 x 20mm LONG BUTTON HEAD BOLTS (x3).
- ITEM 5 = M6 x 12mm LONG COUNTERSUNK BOLTS (x2)
- ITEM 6 = M6 NYLOC NUTS (x4)
- ITEM 7 = M6 WASHERS (x7).
- ITEM 8 = REFLECTOR (x1).
- ITEM 9 = 150mm LENGTH OF HEATSHRINK (x3).
- ITEM 10 = 2.5mm CABLE TIES (x3).
- ITEM 11 = LICENCE PLATE ILLUMINATOR CONNECTOR (CON0007) (x1)

Please note that in cases where kits are packed with rubber washers holding the components onto the bolt – *the rubber washers should be thrown away!*

TOOLS REQUIRED

- Set of metric Allen keys.
- Set of metric sockets and wrench.
 - Phillips screwdriver.
 - Set of spanners.

MAXIMUM TORQUE SETTINGS

- M4 Bolt = 8 Nm
- M5 Bolt = 12 Nm
- M6 Bolt = 15 Nm
- M8 Bolt = 20 Nm

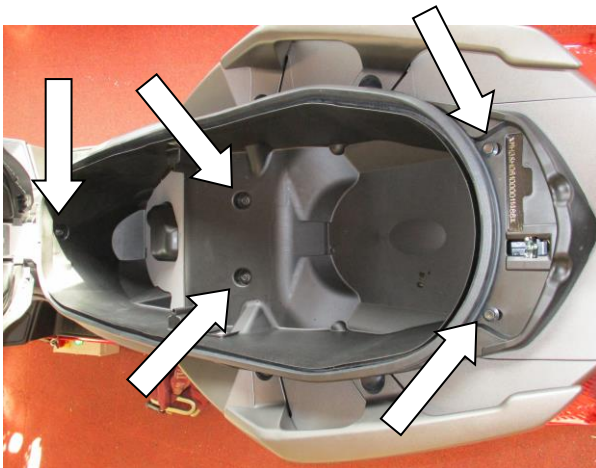

Picture 1



Picture 2

R&G

Unit 1, Shelley's Lane, East Worldham, Alton, Hampshire, GU34 3AQ
Tel: +44 (0)1420 89007 Fax: +44 (0)1420 87301 www.rg-racing.com Email: info@rg-racing.com



Picture 3



Picture 4

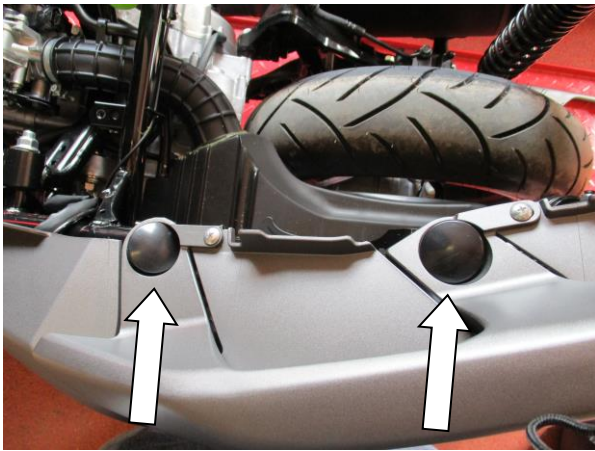

Picture 5

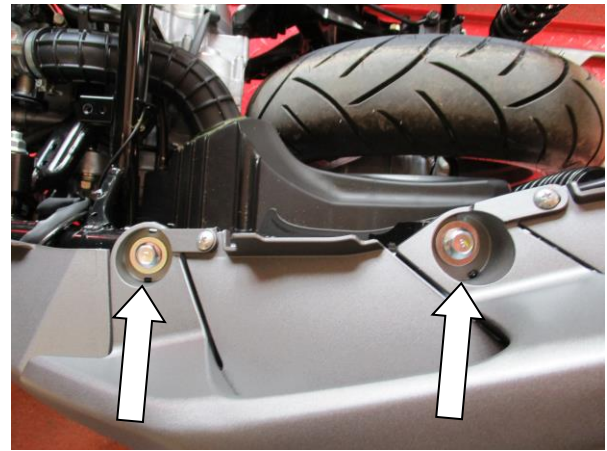

Picture 6



Picture 7



Picture 8



Picture 9

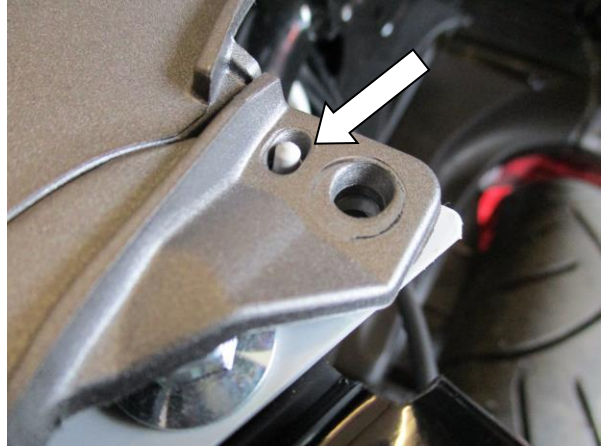

Picture 10



Picture 11



Picture 12

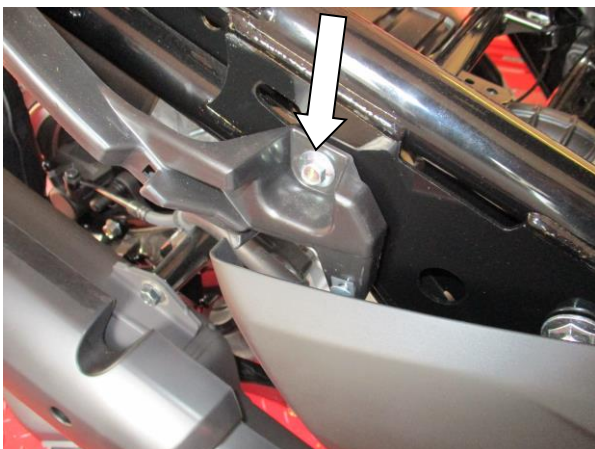

Picture 13



Picture 14



Picture 15



Picture 16

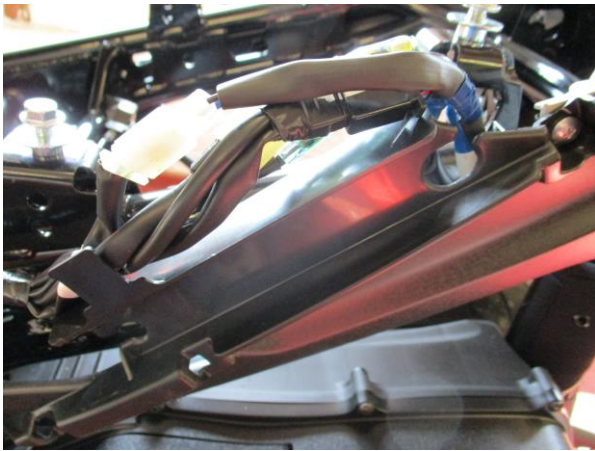

Picture 17



Picture 18



Picture 19

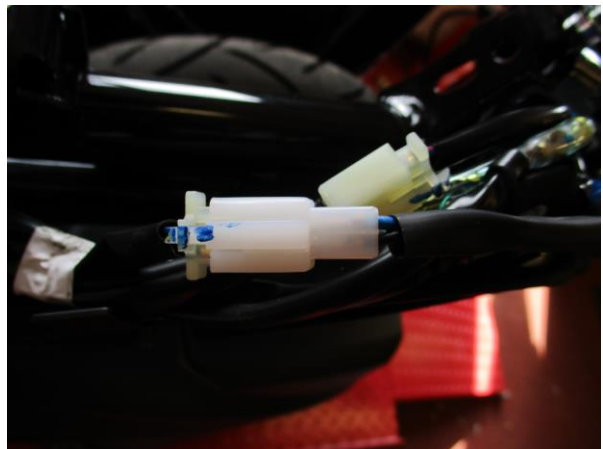

Picture 20

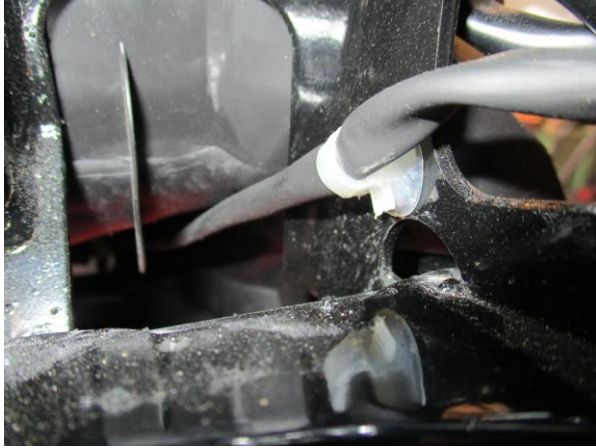

Picture 21

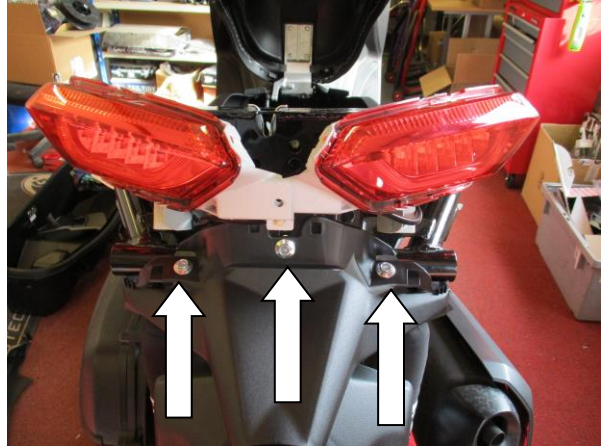

Picture 22

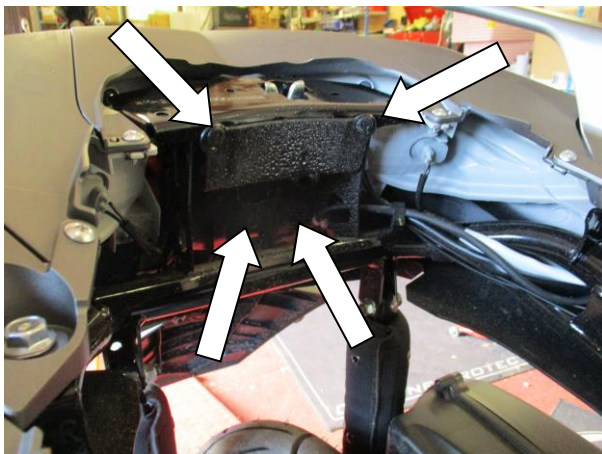

Picture 23



Picture 24

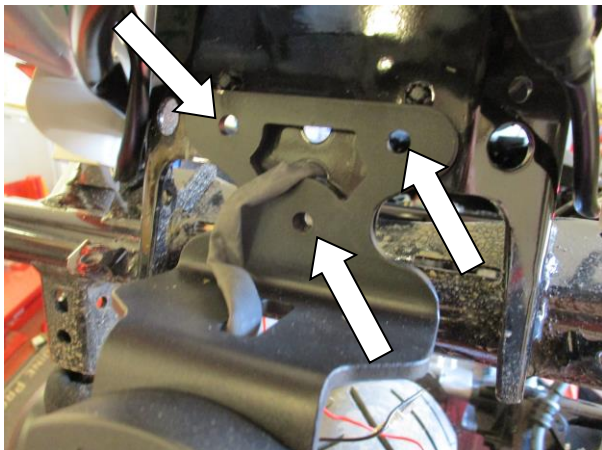

Picture 25

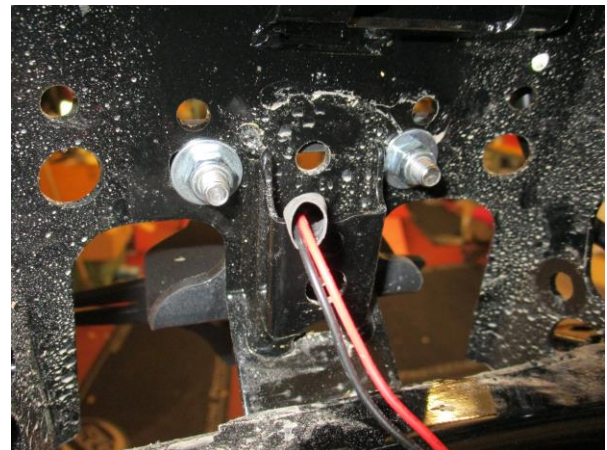

Picture 26

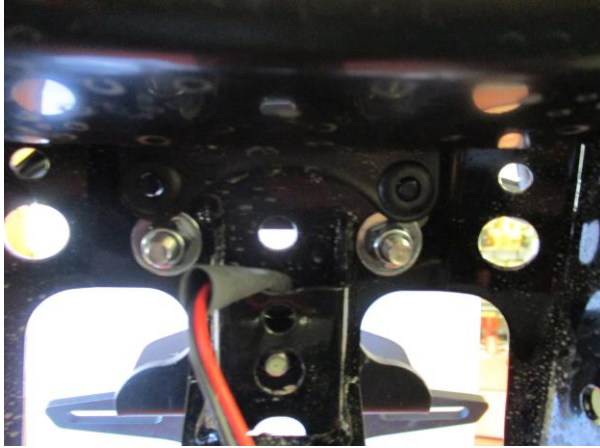

Picture 27

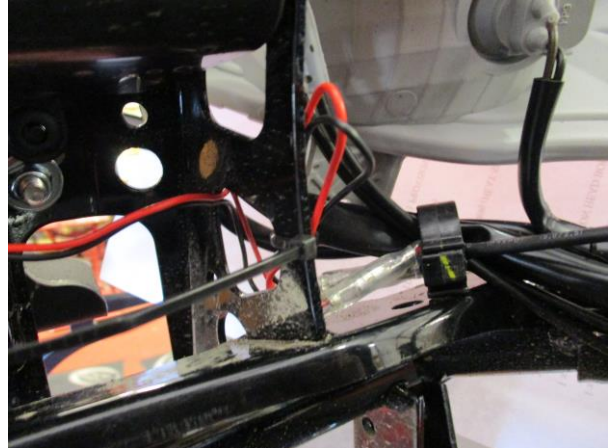

Picture 28



Picture 29

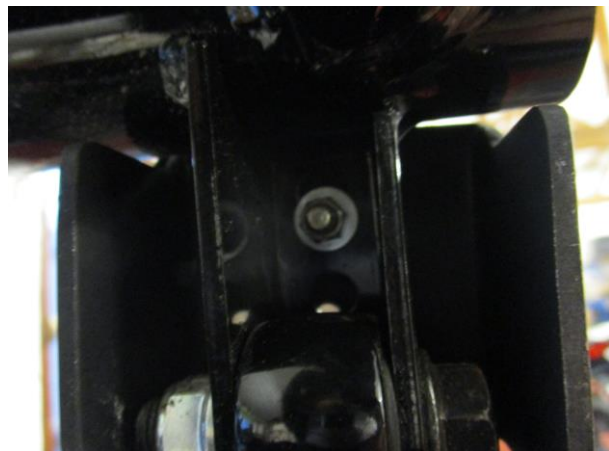

Picture 30

FITTING INSTRUCTIONS

- To fit the R&G tail tidy, lift the seat.
- Remove the five bolts holding the seat compartment in as arrowed in picture 1.
- Lift the seat compartment slightly and locate the compartment light wiring on the left side of the scooter (picture 2). Unplug the 2 bullet connectors. Lift the seat compartment panel back and up making sure that the brackets in picture 3 do not catch on the side panels.
- Remove the rubber caps and bolts holding the passenger handle on as shown in pictures 5 and 6.
- Remove the bolt by the passenger footrests on both sides as shown in picture 7.
- Gently pull back the panel shown in picture 8 until the two rubber poppers holding it to the panel below disengage.
- Remove the bolt and screw now exposed below the panel as arrowed in picture 8.
- Remove the two screws shown in picture 9.
- Lift the edge of the panel over the plastic locator shown in picture 10.
- Slide the panel (picture 11) towards the back of the scooter to remove it.
- To remove the rear wings (picture 12) pull them towards the back of the scooter until the panel disengages from the scooter.

R&G

Unit 1, Shelley's Lane, East Worldham, Alton, Hampshire, GU34 3AQ
Tel: +44 (0)1420 89007 Fax: +44 (0)1420 87301 www.rg-racing.com Email: info@rg-racing.com



- Remove the bolt (picture 13) and screw (picture 14) from both sides.
- Remove the screw between the tail-lights (picture 15).
- Remove the lower tail light screw from both sides (picture 16).
- Lift the wiring harness away from the slots on the left side panel (picture 17).
- Pull each side of the panels away from the scooter so that the 2 side panels and rear panel come away from the bike as one piece (pictures 18 and 19).
- Unplug the connector shown in picture 20.
- Push the clip shown in picture 21 from behind so that it pops out.
- Remove the 3 bolts shown in picture 22 and lift the number plate bracket away from the scooter.
- Remove the 4 plastic push rivets shown in picture 23 so that the cover shown can be removed.
- Fit the licence plate illuminator (item 3) to licence plate bracket part 1 (item 1) and route the wire as shown in picture 24. Add a length of heatshrink (item 9) to the wire as shown to protect it.
- Offer licence plate bracket part 1 (item 1) up to the 3 holes on the scooter shown in picture 25. Place 3 M6 button head bolts (item 4) with an M6 washer (item 7) through these 3 holes. Route the wire as shown in picture 25 and 26.
- The central lower hole has a threaded insert so can be secured and the 2 upper holes require an M6 washer and M6 nyloc nut to secure them in place as shown in picture 26.
- Refit the plastic cover from picture 23 using the 4 plastic push rivets so that the cover sits above the washers as shown in picture 27.
- Fit the licence plate illuminator connector (item 11) to the licence plate illuminator bullet connectors following this scheme:

Illuminator RED-----→Illuminator connector RED
Illuminator BLACK---→Illuminator connector BLACK
- Fit the licence plate illuminator connector to the scooter wiring loom in the same way as the OEM connector was removed in picture 20.
- Test the lights for correct function and swap connectors from above if the licence plate illuminator fails.
- Neatly secure the licence plate illuminator wiring as shown or similar to image 28.
- Fit licence plate bracket part 2 (item 2) to the top of each shock absorber mounting point using an M6 countersunk bolt (item 5) as shown in picture 29 and a washer and M6 nyloc nut as shown in picture 30. Repeat this procedure for the other shock absorber mount.
- Re-fit the bodywork and the hand rails in a reverse procedure of how they were removed.
- Re-fit the licence plate (it may require drilling).
- Depending on local laws, attach enclosed reflector in an appropriate location.
- Test the licence plate illuminator and all lights before riding.

ISSUE 1 16/11/2017 (HB)

Digital copies of these instructions are available to download from www.rg-racing.com

CONSUMER NOTICE

The catalogue description and any exhibition of samples are only broad indications of the Products and R&G may make design changes which do not diminish their performance or visual appeal and supplying them in such state shall conform to the order. The Buyer acknowledges no representation or warranty (other than as to title) has been given or will apply to the Products other than those in R&G's order or confirmation and the Buyer confirms it has chosen the Products as being of merchantable quality and suitable for its particular purposes. Where R&G fits the Products or undertakes other services it shall exercise reasonable skill and care and rectify any fault free of charge unless the workmanship has been disturbed. The Buyer is responsible for ensuring that the warranty on the motorcycle is not affected by the fitting of the Products. On return of any defective Products R&G shall at its option either supply a replacement or refund the purchase money but shall not be liable if the Products have been modified or used or maintained otherwise than in accordance with R&G's or manufacturer's instructions and good engineering practice or if the defect arises from accident or neglect. Other than identified above and subject to R&G not limiting its liability for causing death and personal injury, it shall not be liable for

R&G

Unit 1, Shelley's Lane, East Worldham, Alton, Hampshire, GU34 3AQ

Tel: +44 (0)1420 89007 Fax: +44 (0)1420 87301 www.rg-racing.com Email: info@rg-racing.com



indirect or consequential loss and otherwise its liability shall be limited to the amounts paid by the Buyer for the Products or the fitting or service concerned. These terms do not affect the Buyer's statutory rights.

R&G RETURNS POLICY (NON-FAULTY GOODS)

Returns must be pre-authorized (if not pre-authorized the return will be rejected). Goods may only be returned direct to us if they were purchased direct from us (customer must prove if necessary). Otherwise to be returned to original vendor. Goods must be in re-sellable condition, in the opinion of R&G. All returns are subject to a 25% restocking and handling fee (25% of the gross value exc. P&P – at the prevailing price at time of purchase). The customer must pay any and all carriage charges. No returns of discontinued products, unless within 14 days of purchase. This policy does not affect your statutory rights and does not refer to faulty goods.

R&G

Unit 1, Shelley's Lane, East Worldham, Alton, Hampshire, GU34 3AQ

Tel: +44 (0)1420 89007 Fax: +44 (0)1420 87301 www.rg-racing.com Email: info@rg-racing.com



**NOTICE DE MONTAGE POUR LP0236BK SUPPORT DE PLAQUE
YAMAHA X-MAX '17-**



**Le kit contient les articles exposés ci-dessous, vérifier que toutes les pièces soient présentes avant de
procéder au montage.**

**La façon dont le kit est emballé ne correspond pas forcément à la façon de monter les pièces sur la moto.
LES PARTIES PRESENTEES PEUVENT ETRE UNIQUEMENT REPRESENTATIVES (POUR LA
CLARTE DES INSTRUCTIONS UNIQUEMENT.**

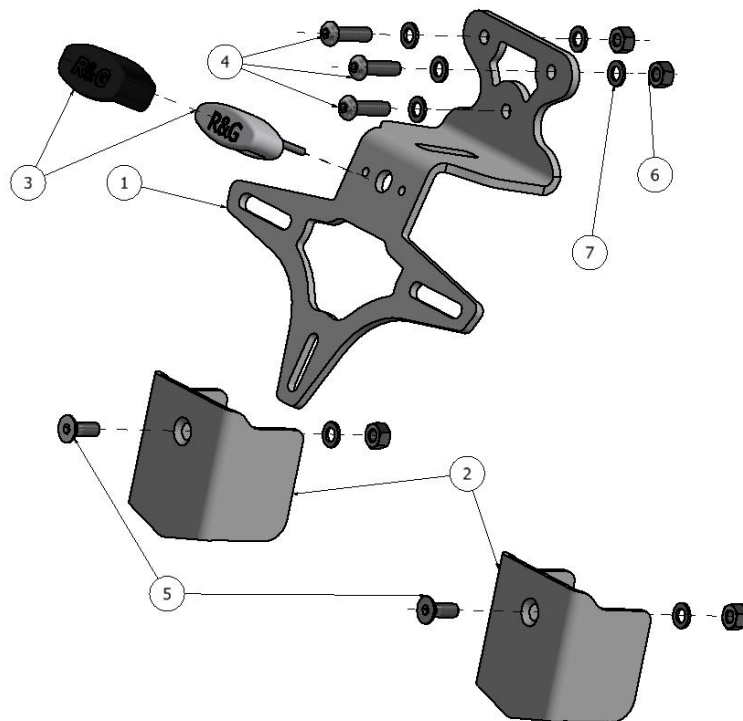

R&G

Unit 1, Shelley's Lane, East Worldham, Alton, Hampshire, GU34 3AQ
Tel: +44 (0)1420 89007 Fax: +44 (0)1420 87301 www.rg-racing.com Email: info@rg-racing.com

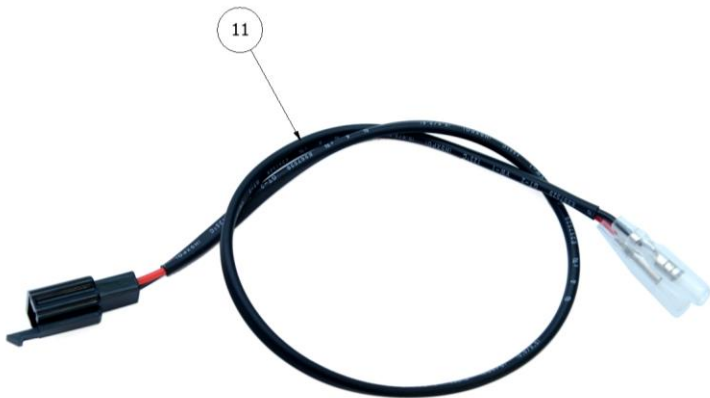
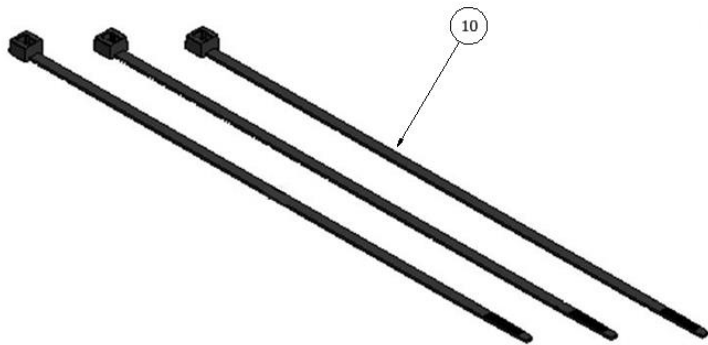
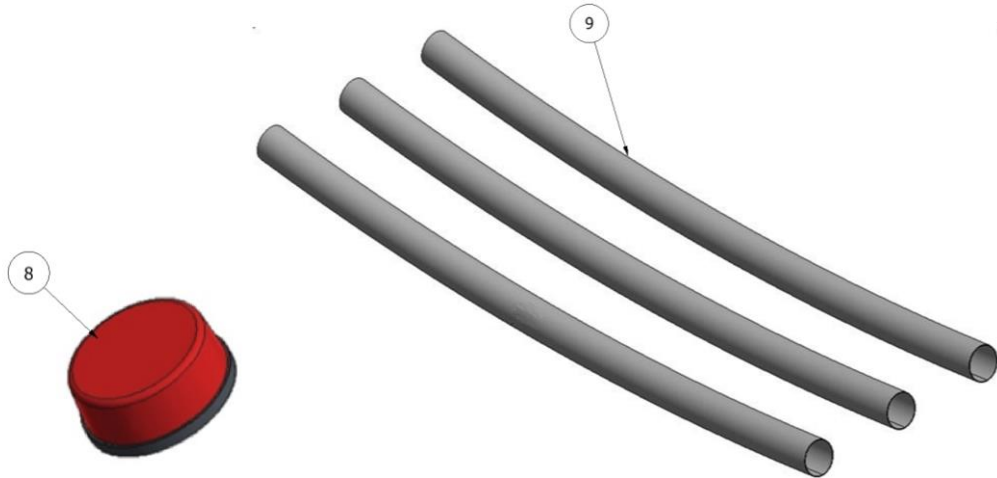



LÉGENDE

ARTICLE 1 = SUPPORT DE PLAQUE PARTIE 1 (TB0236 PARTIE 1) (x1).

ARTICLE 2 = SUPPORT DE PLAQUE PARTIE 2 (TB0236 PARTIE 2) (x2).

ARTICLE 3 = FEU & LINCEUL DE PLAQUE (LA0002) (x1).

ITEM 4 = M6 x 20mm BOULONS (x3).

ITEM 5 = M6 x 12mm BOULONS (x2)

ITEM 6 = M6 ÉCROUS (x4)

ITEM 7 = M6 RONDELLES (x7).

ITEM 8 = RÉFLECTEUR (x1).

ITEM 9 = 150mm MANCHON THERMO RÉTRACTABLE (x3).

ITEM 10 = 2.5mm COLLIERS DE SERRAGE (x3).

ITEM 11 = CONNECTEUR DE FEU DE PLAQUE (CON0007) (x1)

Notez que si les kits sont emballés avec des rondelles en caoutchouc servant à tenir les composants,
ces rondelles doivent être jetées !

OUTILS REQUIS

- Clés Allen.
- Clés à cliquet + douilles.
- Tournevis cruciforme.
- Clés à molette.

VALEURS DE SERRAGE

- M4 BOULON = 8 Nm
- M5 BOULON = 12Nm
- M6 BOULON = 15Nm
- M8 BOULON = 20 Nm

NOTICE DE MONTAGE

- Enlever le siège.
- Enlever les 5 boulons qui fixent le compartiment de siège, voir photo 1.
- Lever le compartiment de siège et placer le compartiment du fil de feu du côté gauche du scooter (photo 2). Débrancher les 2 connecteurs. Lever le panneau du compartiment de siège en veillant à ce que les supports de la photo 3 n'accrochent pas les panneaux latéraux.
- Enlever les capuchons en caoutchouc et les boulons qui fixent la poignée du passager, voir photos 5 and 6.
- Enlever le boulon par les repose pied passager des 2 côtés, voir photo 7.
- Tirer doucement le panneau, voir photo 8 jusqu'à ce que les 2 morceaux de caoutchouc qui fixent le bas du panneau soient désengagés.
- Enlever le boulon et la vis exposées au-dessous du panneau, voir photo 8.
- Enlever les 2 vis, voir photo 9.
- Lever le bord du panneau au niveau de l'onglet en plastique, voir photo 10.
- Glisser le panneau (photo 11) vers le bas du scooter pour l'enlever.

R&G

Unit 1, Shelley's Lane, East Worldham, Alton, Hampshire, GU34 3AQ

Tel: +44 (0)1420 89007 Fax: +44 (0)1420 87301 www.rg-racing.com Email: info@rg-racing.com



- Pour enlever les ailes arrière (photo 12) tirez les vers le bas du scooter jusqu'à ce que le panneau se désengage du scooter.
- Enlever le boulon (photo 13) et la vis (photo 14) des 2 côtés.
- Enlever la vis située entre les feux de plaque (photo 15).
- Enlever le support de feu inférieur, vissé des 2 côtés (photo 16).
- Enlever le harnais de fils de ses fentes sur le panneau du côté gauche (photo 17).
- Tirer chaque côté des panneaux du scooter de façon à ce que les 2 panneaux latéraux et le panneau arrière s'enlèvent de la moto en un seul morceau (photos 18 et 19).
- Débrancher le connecteur indiqué sur la photo 20.
- Pousser le clip indiqué sur la photo 21 depuis l'arrière pour qu'il s'enlève.
- Enlever les 3 boulons indiqués sur la photo 22 puis lever le support de plaque du scooter.
- Enlever les 4 rivets indiqués sur la photo 23 de façon à ce que le couvercle indiqué puisse être enlevé.
- Monter le feu de plaque (article 3) sur le support de plaque partie 1 (article 1) puis router le fil comme indiqué sur la photo 24. Ajouter une longueur de manchon thermo rétractable (article 9) sur le fil pour le protéger.
- Monter le support de plaque partie 1 (article 1) sur les 3 trous sur le scooter indiqué sur la photo 25. Placer les 3 boulons M6 (article 4) avec une rondelle M6 (article 7) dans ces 3 trous. Router le fil indiqué sur les photos 25 et 26.
- Le trou central le plus bas possède un insert fileté qui peut être sécurisé et les 2 trous supérieurs nécessitent une rondelle M6 et un écrou M6 pour les fixer en place, voir photo 26.
- Remonter le cache plastique de la photo 23 en utilisant les 4 rivets de façon à ce que le cache se place sur les rondelles, voir photo 27.
- Monter le connecteur de feu de plaque (article 11) sur les connecteurs de feux de plaque selon ce schéma :
Feu ROUGE----->Connecteur de feu ROUGE
Feu NOIR---> Connecteur de feu NOIR
- Monter le connecteur de feu de plaque sur le faisceau de fils du scooter de la même façon que le connecteur d'origine a été enlevé, voir photo 20.
- Tester les feux pour vérifier leur fonctionnement puis tournez les connecteurs par-dessus si le feu de plaque ne s'éclaire pas.
- Fixer les fils de feu de plaque, voir image 28.
- Monter le support de plaque partie 2 (article 2) sur le haut de chaque point de fixation de l'absorbeur de choc en utilisant un boulon M6 (article 5) voir photo 29 et une rondelle et un écrou M6 voir photo 30. Répéter cette procédure pour l'autre absorbeur de choc.
- Remonter le carénage et les rails d'accroche en procédant à l'inverse du montage.
- Remonter la plaque d'immatriculation (peut nécessiter un perçage).
- Selon la loi locale, positionner les réflecteurs aux endroits appropriés.
- Tester les clignotants et le feu de plaque pour vérifier le fonctionnement et le niveau d'éclairage.

ISSUE 1 16/11/2017 (HB)

Notice disponible au téléchargement sur www.rg-racing.com

CONSUMER NOTICE

The catalogue description and any exhibition of samples are only broad indications of the Products and R&G may make design changes which do not diminish their performance or visual appeal and supplying them in such state shall conform to the order. The Buyer acknowledges no representation or warranty (other than as to title) has been given or will apply to the Products other than those in R&G's order or confirmation and the Buyer confirms it has chosen the Products as being of merchantable quality and suitable for its particular purposes. Where R&G fits the Products or undertakes other services it shall exercise reasonable skill and care and rectify any fault free of charge unless the workmanship has been disturbed. The Buyer is responsible for ensuring that the warranty on the motorcycle is not affected by the fitting of the Products. On return of any defective Products R&G shall at its option either supply a replacement or refund the purchase money but shall not be liable if the Products have been modified or used or maintained otherwise than in accordance with R&G's or manufacturer's instructions and good engineering practice or if the defect arises from accident or neglect. Other than identified above and subject to R&G not limiting its liability for causing death and personal injury, it shall not be liable for

R&G

Unit 1, Shelley's Lane, East Worldham, Alton, Hampshire, GU34 3AQ

Tel: +44 (0)1420 89007 Fax: +44 (0)1420 87301 www.rg-racing.com Email: info@rg-racing.com



indirect or consequential loss and otherwise its liability shall be limited to the amounts paid by the Buyer for the Products or the fitting or service concerned. These terms do not affect the Buyer's statutory rights.

R&G RETURNS POLICY (NON-FAULTY GOODS)

Returns must be pre-authorized (if not pre-authorized the return will be rejected). Goods may only be returned direct to us if they were purchased direct from us (customer must prove if necessary). Otherwise to be returned to original vendor. Goods must be in re-sellable condition, in the opinion of R&G. All returns are subject to a 25% restocking and handling fee (25% of the gross value exc. P&P – at the prevailing price at time of purchase). The customer must pay any and all carriage charges. No returns of discontinued products, unless within 14 days of purchase. This policy does not affect your statutory rights and does not refer to faulty goods.

R&G

Unit 1, Shelley's Lane, East Worldham, Alton, Hampshire, GU34 3AQ

Tel: +44 (0)1420 89007 Fax: +44 (0)1420 87301 www.rg-racing.com Email: info@rg-racing.com



**MONTAGEANLEITUNG FÜR LP0236BK KENNZEICHENHALTER
YAMAHA X-MAX '17-**



ALLE KIT-TEILE SIND UNTEN ABGEBILDET UND GEKENNZEICHNET. BEVOR SIE MIT DER MONTAGE BEGINNEN, ÜBERPRÜFEN SIE, DASS ALLE TEILE VORHANDEN SIND.

Hinweis: Die Verpackung der Teile stellt nicht die Reihenfolge der Montage dar.

DIE UNTEN ABGEBILDETEN TEILE DIENEN LEDIGLICH ZUR ERKLÄRUNG

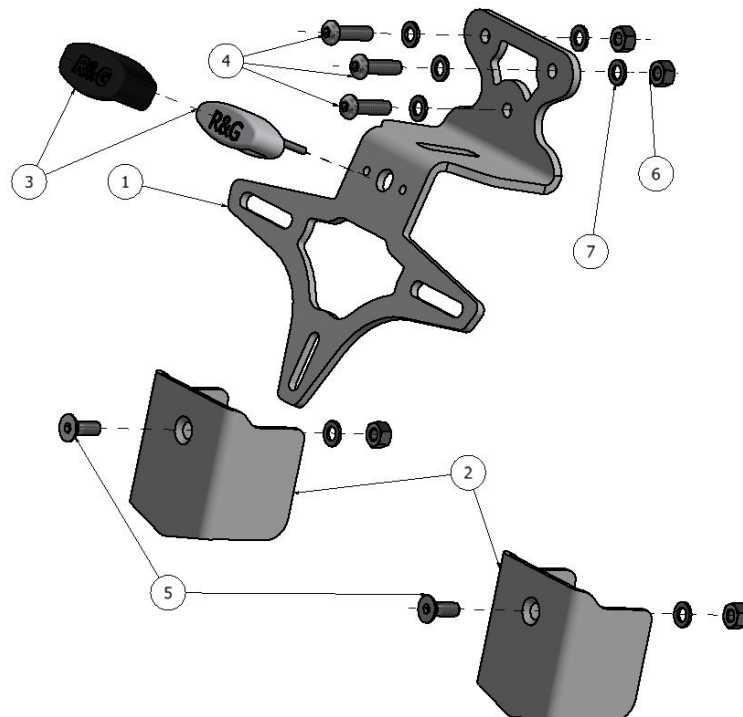

R&G

Unit 1, Shelley's Lane, East Worldham, Alton, Hampshire, GU34 3AQ
Tel: +44 (0)1420 89007 Fax: +44 (0)1420 87301 www.rg-racing.com Email: info@rg-racing.com

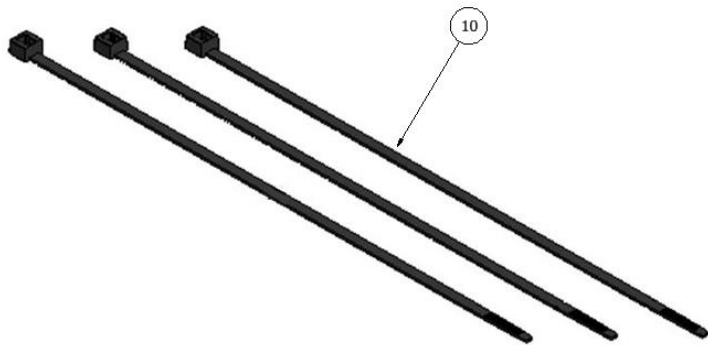
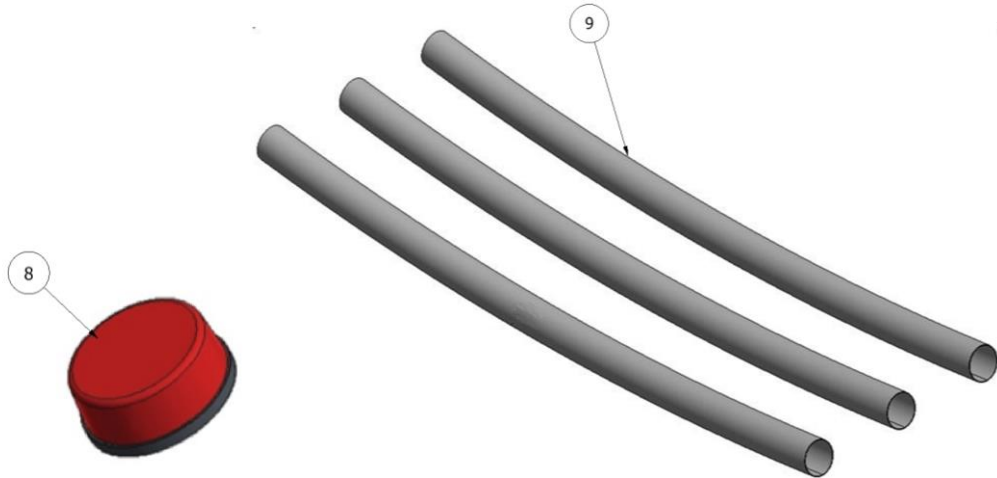



LIEFERUMFANG

- ARTIKEL 1 = KENNZEICHENHALTER TEIL 1 (TB0236 TEIL 1) (x1)
- ARTIKEL 2 = KENNZEICHENHALTER TEIL 2 (TB0236 TEIL 2) (x2)
- ARTIKEL 3 = KENNZEICHENBELEUCHTUNG & ABDECKUNG (LA0002) (x1)
- ARTIKEL 4 = M6 x 20mm INBUSSCHRAUBE (x3)
- ARTIKEL 5 = M6 x 12mm SENKSCHRAUBEN (x2)
- ARTIKEL 6 = M6 SELBSTSICHERNDE MUTTER (x4)
- ARTIKEL 7 = M6 UNTERLEGSSCHEIBE (x7)
- ARTIKEL 8 = RÜCKSTRAHLER (x1)
- ARTIKEL 9 = 150mm SCHRUMPFSCHLAUCH (x3)
- ARTIKEL 10 = 2,5mm KABELBINDER (x3)
- ARTIKEL 11 = KABELVERBINDER (CON0007) (x1)

Hinweis für Kits mit Plastikunterlegscheiben an den Schrauben – *Diese Plastikunterlegscheiben werden nicht für den Einbau benötigt!*

SIE BENÖTIGEN FOLGENDES WERKZEUG

- Satz Inbusschlüssel
- Steckschlüsselsatz mit Verlängerungen
- Kreuzschlitzschraubenzieher
- Schraubenschlüssel

- **MAXIMALE ANZUGSDREHMOMENTE:**
 - M4 SCHRAUBE = 8Nm
 - M5 SCHRAUBE = 12Nm
 - M6 SCHRAUBE = 15Nm
 - M8 SCHRAUBE = 20Nm

MONTAGEANLEITUNG

- Um den R&G Kennzeichenhalter montieren zu können, zuerst den Sitz hochklappen.
- Entfernen Sie die fünf Schrauben, die das Staufach befestigen – siehe Abbildung 1.
- Das Staufach etwas anheben und die Kabel für die Beleuchtung an der linken Seite des Rollers orten (Abbildung 2). Die zwei Kabelverbinder abstecken. Das Verkleidungsteil für das Staufach nach hinten und nach oben heben und hierbei darauf achten, dass die Halterungen in Abbildung 3 nicht an den Seitenverkleidungsteilen hängen bleiben.
- Entfernen Sie die Gummikappen und Schrauben, die den Haltegriff, der in Abbildungen 5 und 6 abgebildet ist, befestigen.
- Entfernen Sie die Schraube in der Nähe der Fußraste an beiden Seiten des Motorrads – siehe Abbildung 7.
- Vorsichtig das Verkleidungsteil (Abbildung 8) nach hinten ziehen bis die zwei Gummi-Halterungsknöpfe sich lösen.
- Entfernen Sie den jetzt hervorstehenden Bolzen und die Schraube unter dem Verkleidungsteil wie in Abbildung 8 gekennzeichnet.
- Entfernen Sie die zwei Schrauben, die in Abbildung 9 abgebildet sind.
- Heben Sie die Ecke des Verkleidungsteils über den Plastikstift, der in Abbildung 10 abgebildet ist.
- Schieben Sie das Verkleidungsteil (Abbildung 11) nach hinten, um es zu entfernen.

R&G

Unit 1, Shelley's Lane, East Worldham, Alton, Hampshire, GU34 3AQ
Tel: +44 (0)1420 89007 Fax: +44 (0)1420 87301 www.rg-racing.com Email: info@rg-racing.com



- Um die hinteren Heckflügel zu entfernen (Abbildung 12) – diese nach Hinten ziehen, bis das Verkleidungsteil sich vom Roller lost.
- Entfernen Sie den Bolzen (Abbildung 13) und die Schraube (Abbildung 14) an beiden Seiten.
- Entfernen Sie die Schraube zwischen den Heckleuchten (Abbildung 15).
- Entfernen Sie die untere Schraube für die Rückbeleuchtung an beiden Seiten (Abbildung 16).
- Heben Sie den Kabelbaum weg von den Schlitzen am linken Verkleidungsteil (Abbildung 17).
- Beide Seitenverkleidungsteile vom Roller so wegziehen, dass die zwei Seitenverkleidungsteile und das hintere Verkleidungsteil sich als komplette Einheit vom Motorrad löst (Abbildungen 18 und 19).
- Trennen Sie den Steckverbinder, der in Abbildung 20 abgebildet ist.
- Drücken Sie den Clip, der in Abbildung 21 abgebildet ist, von hinten, sodass er rausspringt.
- Entfernen Sie die 3 Schrauben, die in Abbildung 22 abgebildet sind, und die Kennzeichenhalterung vom Motorrad wegziehen.
- Entfernen Sie die vier Plastiknieten, die in Abbildung 23 abgebildet sind, sodass die abgebildete Abdeckung entfernt werden kann.
- Montieren Sie die Kennzeichenbeleuchtung (Artikel 3) am Kennzeichenhalter Teil 1 (Artikel 1) und das Kabel wie in Abbildung 24 abgebildet verlegen. Um das Kabel zu schützen, 1 x Schrumpfschlauch (Artikel 9) anbringen wie abgebildet.
- Den Kennzeichenhalter Teil 1 (Artikel 1) an den 3 Öffnungen am Roller positionieren – siehe Abbildung 25. Dann 3 x M6 Inbusschrauben (Artikel 4) mit je einer M6 Unterlegscheibe (Artikel 7) in die 3 Öffnungen einführen. Verlegen Sie die Verkabelung wie in den Abbildung 25 und 26 abgebildet.
- Die mittlere, untere Öffnung hat einen Gewindeeinsatz, der gesichert werden kann, und die 2 oberen Öffnungen benötigen eine M6 Unterlegscheibe und eine M6 selbstsichernde Mutter, um sie in Position zu befestigen –siehe Abbildung 26.
- Montieren Sie die Plastikabdeckung (Abbildung 23) wieder mit den 4 Plastiknieten, sodass die Abdeckung über den in Abbildung 27 abgebildeten Unterlegscheiben sitzt.
- Montieren Sie die Kabelverbinder für die Kennzeichenbeleuchtung (Artikel 11) mit den Verbindern für die Kennzeichenbeleuchtung wie folgt:
 - Beleuchtung ROT ----->Kabelverbinder Beleuchtung ROT
 - Beleuchtung SCHWARZ---> Kabelverbinder Beleuchtung SCHWARZ
- Die Kabelverbinder am Kabelbaum anbringen auf gleicher Weise wie die original Kabelverbinder entfernt wurde – siehe Abbildung 20.
- Überprüfen Sie die Funktion der kompletten Beleuchtung - Falls die Kennzeichenbeleuchtung nicht funktionieren sollte, tauschen Sie die Kabelverbinder untereinander.
- Die Verkabelung der Kennzeichenbeleuchtung ordentlich sichern und verstauen, wie in Abbildung 28 abgebildet.
- Montieren Sie den Kennzeichenhalter Teil 2 (Artikel 2) oben an den Montagepunkten für den Stoßdämpfer mit je einer M6 Senkschraube (Artikel 5), wie in Abbildung 29 abgebildet, sowie einer Unterlegscheibe und einer M6 selbstsichernden Mutter, wie in Abbildung 30 abgebildet. Diesen Vorgang an der zweiten Stoßdämpfer-Halterung wiederholen.
- Montieren Sie die Verkleidungsteile und die Haltegriffe wieder.
- Montieren Sie das amtliche Kennzeichen (Bohrungen im Kennzeichen evtl. notwendig).
- Entsprechend der gesetzlichen Vorschriften, den mitgelieferten Rückstrahler anbringen.
- Überprüfen Sie die Funktion der Beleuchtung (Blinker und Kennzeichenhalter-Beleuchtung) vor Gebrauch des Fahrzeuges.

AUSGABE 1 16/11/2017 (HB)

Eine digitale Version dieser Montageanleitung kann auf folgender Seite heruntergeladen werden:

www.rg-racing.com

R&G

Unit 1, Shelley's Lane, East Worldham, Alton, Hampshire, GU34 3AQ

Tel: +44 (0)1420 89007 Fax: +44 (0)1420 87301 www.rg-racing.com Email: info@rg-racing.com



CONSUMER NOTICE

The catalogue description and any exhibition of samples are only broad indications of the Products and R&G may make design changes which do not diminish their performance or visual appeal and supplying them in such state shall conform to the order. The Buyer acknowledges no representation or warranty (other than as to title) has been given or will apply to the Products other than those in R&G's order or confirmation and the Buyer confirms it has chosen the Products as being of merchantable quality and suitable for its particular purposes. Where R&G fits the Products or undertakes other services it shall exercise reasonable skill and care and rectify any fault free of charge unless the workmanship has been disturbed. The Buyer is responsible for ensuring that the warranty on the motorcycle is not affected by the fitting of the Products. On return of any defective Products R&G shall at its option either supply a replacement or refund the purchase money but shall not be liable if the Products have been modified or used or maintained otherwise than in accordance with R&G's or manufacturer's instructions and good engineering practice or if the defect arises from accident or neglect. Other than identified above and subject to R&G not limiting its liability for causing death and personal injury, it shall not be liable for indirect or consequential loss and otherwise its liability shall be limited to the amounts paid by the Buyer for the Products or the fitting or service concerned. These terms do not affect the Buyer's statutory rights.

R&G RETURNS POLICY (NON-FAULTY GOODS)

Returns must be pre-authorized (if not pre-authorized the return will be rejected). Goods may only be returned direct to us if they were purchased direct from us (customer must prove if necessary). Otherwise to be returned to original vendor. Goods must be in re-sellable condition, in the opinion of R&G. All returns are subject to a 25% restocking and handling fee (25% of the gross value exc. P&P – at the prevailing price at time of purchase). The customer must pay any and all carriage charges. No returns of discontinued products, unless within 14 days of purchase. This policy does not affect your statutory rights and does not refer to faulty goods.

R&G

Unit 1, Shelley's Lane, East Worldham, Alton, Hampshire, GU34 3AQ

Tel: +44 (0)1420 89007 Fax: +44 (0)1420 87301 www.rg-racing.com Email: info@rg-racing.com